

Weight: 10 lbs./ 4.54 kgs

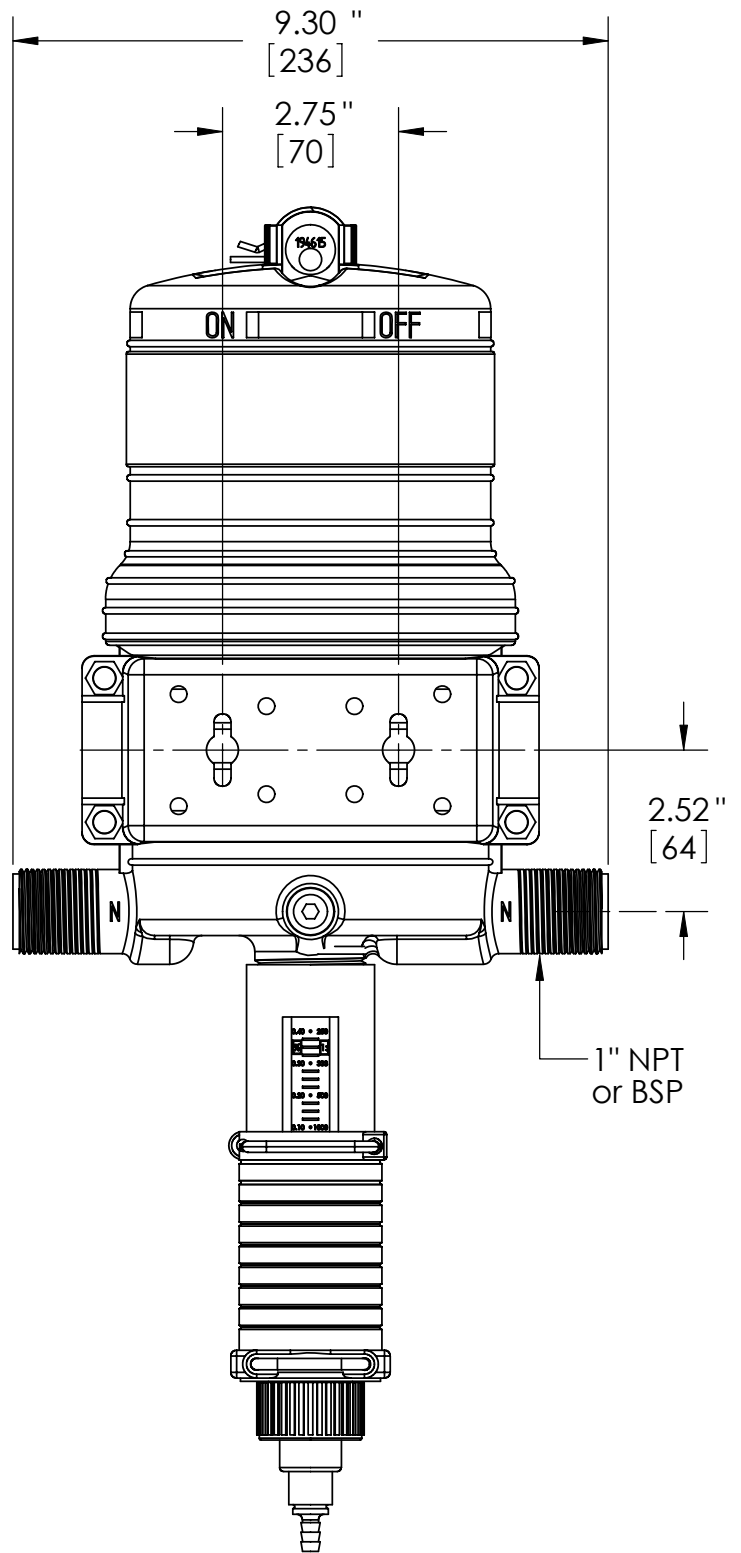
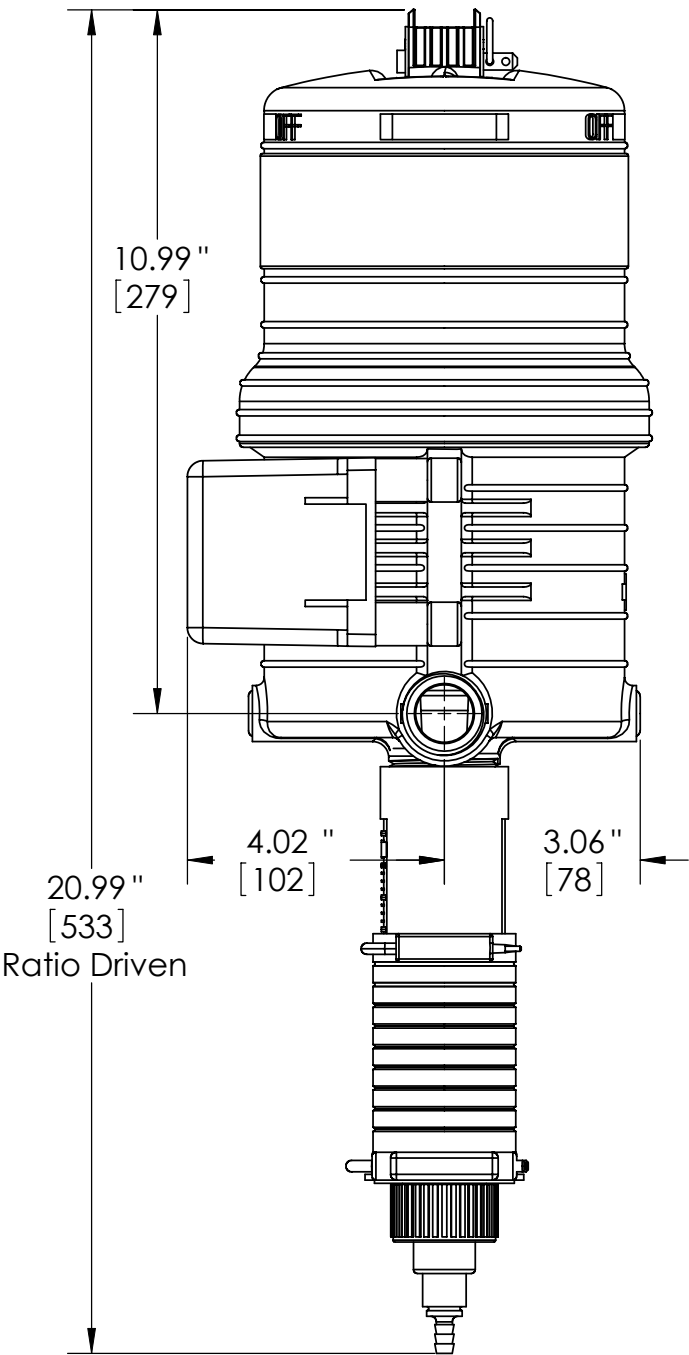

**DOSMATIC USA INC.**

TITLE: SuperDos 15-20 Dim

SIZE	DWG. NO.	REV
<b>A</b>	501455 SuperDos 15-20 Dim	-

All Dimensions are Reference Only

"This document contains confidential information which is the property of Dosmatic USA, Inc. Carrollton, Texas 75006 and it may not be reproduced, transferred, used or it's contents disclosed without the written consent of Dosmatic USA, Inc (800) 344-6767"

**10 lbs./4.54 kg**

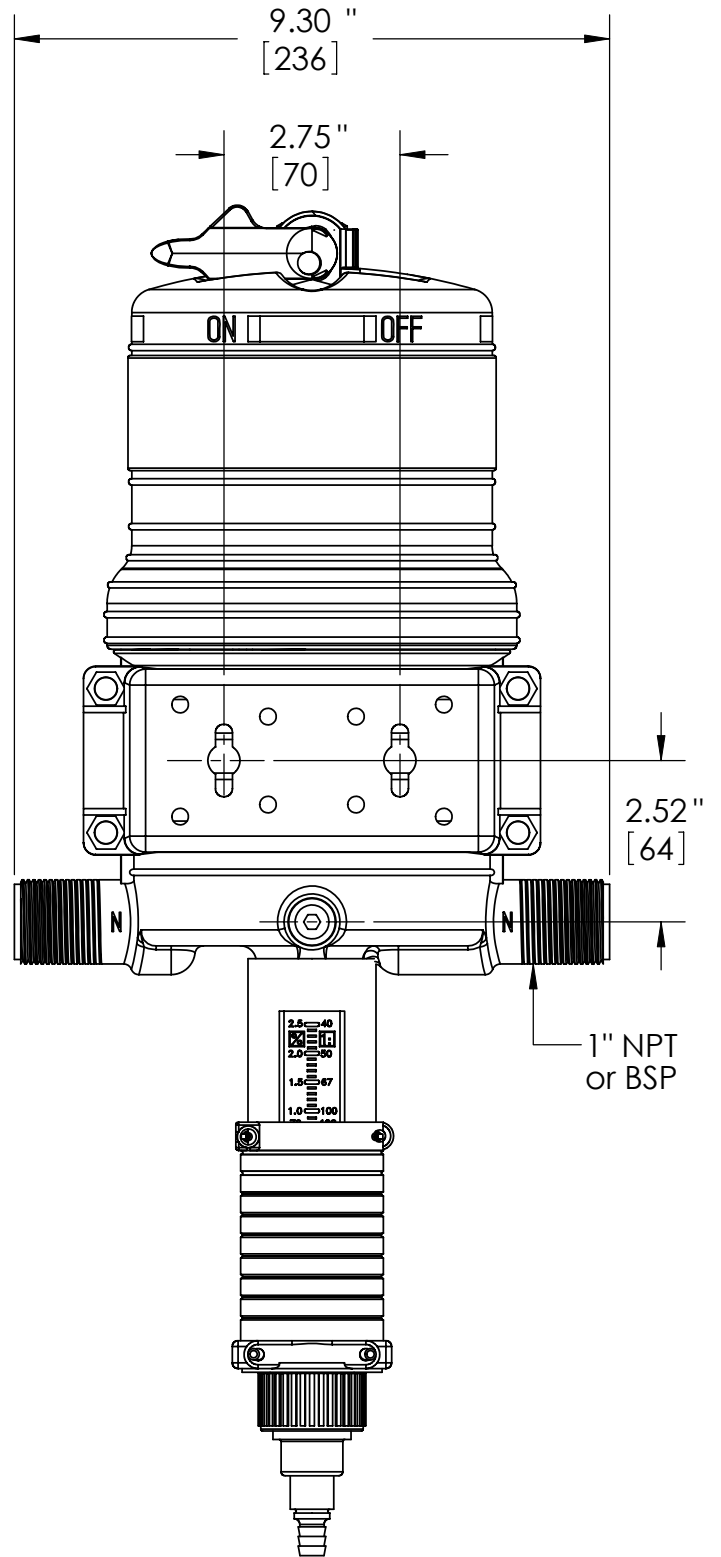
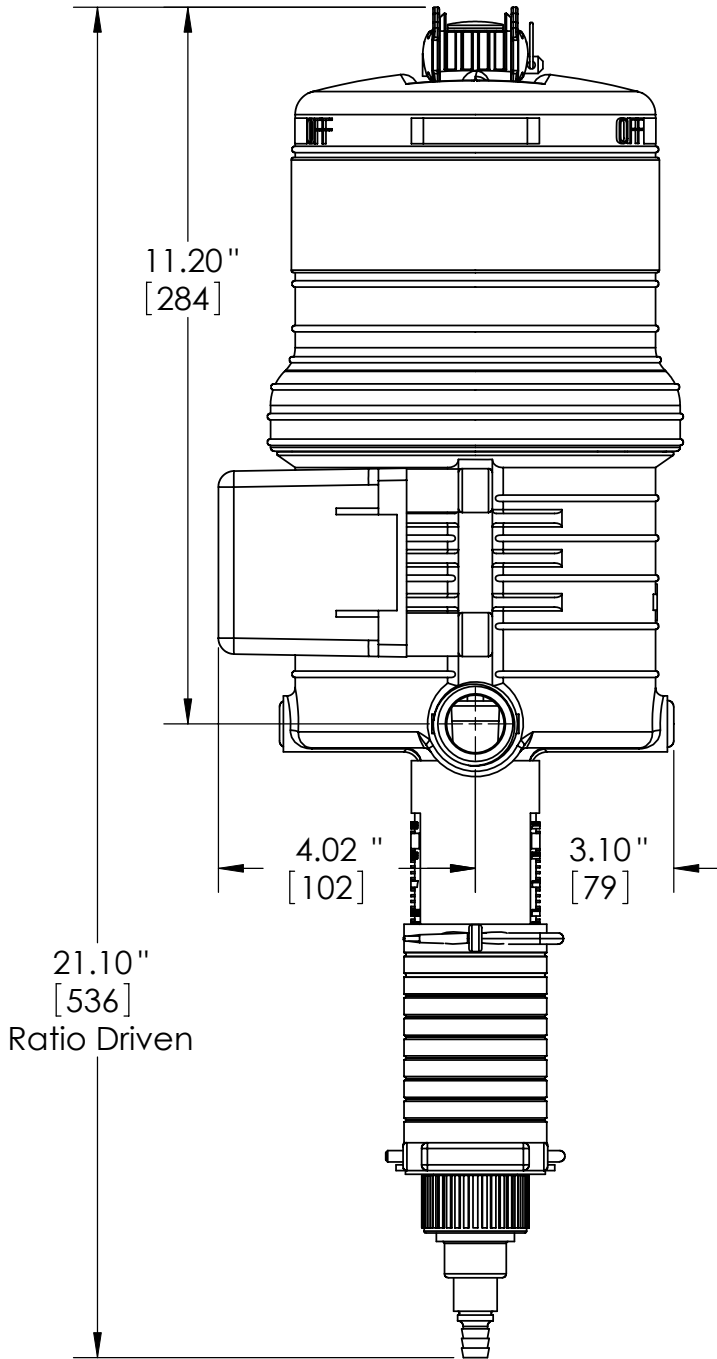

**DOSMATIC USA INC.**

TITLE:

SuperDos 30  
Dimensions

SIZE

**A**

DWG. NO.

501438 SuperDos 30

REV

—

"This document contains confidential information which is the property of Dosmatic USA, Inc. Carrollton, Texas 75006 and it may not be reproduced, transferred, used or it's contents disclosed without the written consent of Dosmatic USA, Inc (800) 344-6767"

All Dimensions are Reference Only

**Weight: 10lbs or 4.54kg**

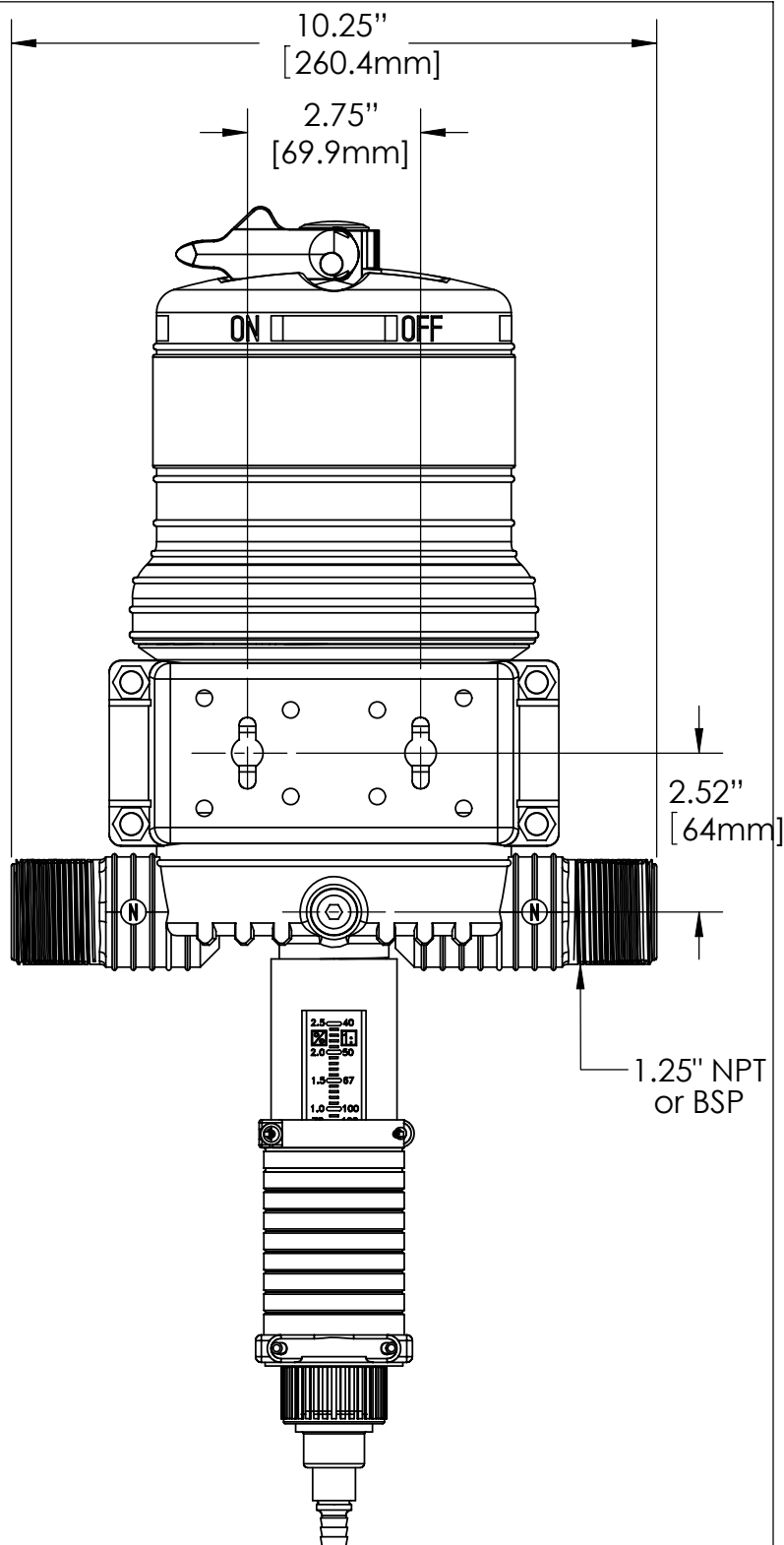
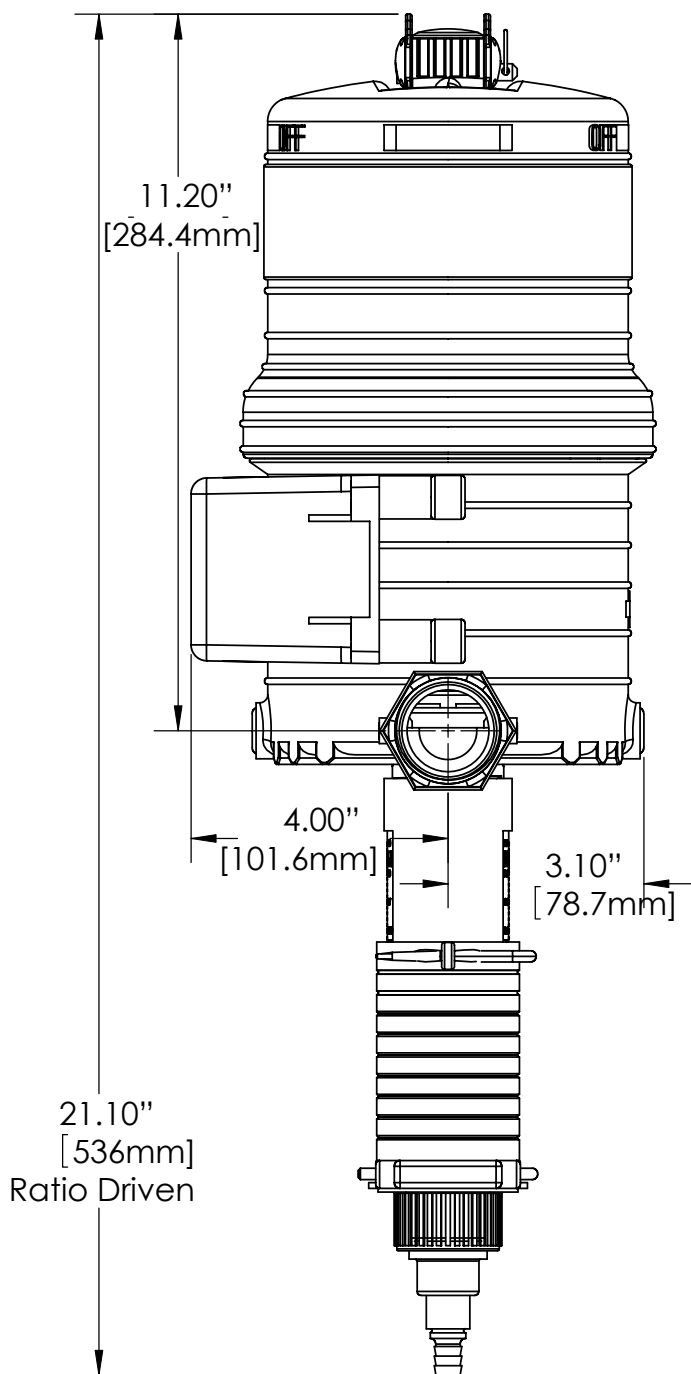

## DOSMATIC USA INC.

TITLE:

SuperDos 45  
Dimensions

SIZE

**A**

DWG. NO.

501436 SuperDos 45 2.5%

REV

—

"This document contains confidential information which is the property of Dosmatic USA, Inc. Carrollton, Texas 75006 and it may not be reproduced, transferred, used or it's contents disclosed without the written consent of Dosmatic USA, Inc (800) 344-6767"

All Dimensions are Reference Only